

GROUND FLOOR

FIRST FLOOR

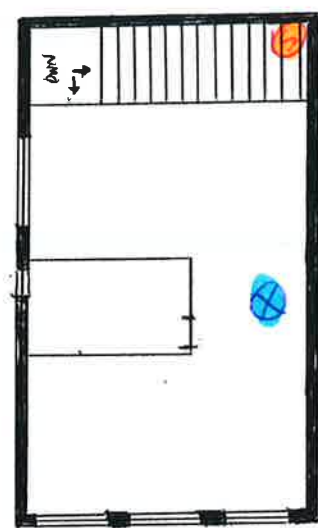

- ⊗ = HEAT/SMOKE ALARM
- ⊙ = SIREN
- CP = CALL POINT
- = ALARM PANEL
- EXIT = EXIT SIGNAGE
- = 15min FRM CEILING & STAIRS
- = ESCAPE PATH

OPARAU ROADHOUSE

STATE HIGHWAY 31 OPARAU

EVACUATION POINT =  
PICNIC TABLES

PRINCIPAL ENTRANCE